

Your **FREE** PROJECT CHECKLIST INSIDE THE VERY LATEST TRENDS AND LAUNCHES | STUNNING REAL PROJECTS

KITCHENS BEDROOMS & BATHROOMS

BRITAIN'S
BEST-SELLING
KITCHEN,
BEDROOM AND
BATHROOM
MAGAZINE

DECEMBER 2022
£5.99

KITCHENS PERFECT FOR

festive entertaining

FROM PRACTICAL PREP SPACE AND SOCIAL DINING ZONES TO FANCY HOME BARS

ALL YOU NEED
TO KNOW
about large
appliances

INSIDE

ISLANDS THAT DO MORE

- + pop-up gin bars
- + banquette seating
- + split-level dining
- + clever storage

TAYLISTmedia



thesethreerooms.com

Cover story

“These seating areas really come into their own when we have a relaxed supper with friends.”



Natural light pours in through the sash windows, balancing the dark materials. **Barstools and dining table**, Chaplins.

The FACTS

Who? Kat and Steve Habershon, with their rescue dog Rossi

What A new kitchen-diner.

Where Hertfordshire

Cost Halcyon Interiors kitchens start from £28,000

Time Six months

Kat and Steve Habershon had white marble in their former home's kitchen – but this time they went for something a little moodier >

Words: **Amelia Thorpe**
Photography: **Nick Smith**

LET'S GO DARK

A CHANCE CALL

from their former landlord of 10 years set Kat and Steve Habershon on an eventful journey.

"He rang us on the off-chance to ask for our opinion on a property for sale down our road," Kat describes.

"He knew we had just finished

renovating our house and asked for photos to see what the potential transformation could be. His response? Forget the other house, just let me know when you move."

Kat, an entrepreneur, and Steve, a managing director, enjoyed renovating the property and were keen to do it again. Although they hadn't been planning to sell their freshly-finished home quite so soon, their old landlord's interest – and subsequent offer – was too good of an opportunity. So off they went to visit an interesting property for sale nearby. "Three days later, we had sold our house bought this one," laughs Kat. Larger than their previous home, the five-bedroom double-fronted house was built 33 years ago in a Georgian style. "It has elegant symmetrical proportions and a wonderful feel," she notes. Here, Kat describes how their new kitchen came together...

What was the existing space like and why did you want to replace it?

It had quite a traditional feel, with wooden Shaker-style units around the walls, a small peninsula, and a lot of unused space in the middle of the room. Apart from that, our taste in design is more contemporary.

We had an open-plan kitchen-diner in our previous home and enjoyed having plenty of space to cook, eat and socialise with friends. We realised that there was no need to have a wall separating the kitchen and dining room in this house. Instead, it would make more sense to remove the wall and open up the space, which would also allow us to include a large island as the hub of the room.

Kat's WORDS OF WISDOM

- Consider as many of the details as you can at the start of the project, down to knowing where you want to position electrical sockets. For example, we were able to install one on one end of the island, perfectly situated for the cake mixer.
- Choose drawers for storage, rather than base units. It's so much easier to see the contents.
- I'm indecisive, so I find it helpful to make a Powerpoint presentation of my shortlisted items, for example when choosing barstools. Then I show Steve and it's a great way to whittle down the options and work out the best solution together.
- I do love the pull-out hose on the tap, so I can clean and rinse the whole sink easily. Now I wonder how I ever did without it before.

What led you to Halcyon Interiors?

While renovating our previous home, we had rented a flat in London during the building work. We had popped into Halcyon Interiors showroom on Wigmore Street and met showroom and design manager Graham Robinson. We thought kitchen prices in central London would be mega expensive, but were pleasantly surprised to hear the costs were similar to local companies in Hertfordshire. We also felt we were in really good hands with Graham – he is so knowledgeable, never pushy and listens very carefully. We were so delighted with the kitchen he produced for our old house that we knew we wanted to commission him again for this one.

What was your brief?

We wanted a clean-lined, modern look with a monolithic statement island. Steve loves cooking and we often have family and friends over for meals and drinks, so it needed to be a practical and sociable design. In our previous home, I'd gone for white marble – this time I went for a dark and moody feel. I love the contrast of black against the white cornice, accentuating the Georgian features.

To give Graham a good sense of the dark materials I liked, I made a moodboard with images I found in magazines, on Instagram and Pinterest. He sent back a fantastic selection of samples with ideas for everything. It was a very collaborative process and I love the combination of the dark Cosentino Dekton surface and the black timber cabinets. The fluted wall units in lighter wood break up the design and add interest.

Graham, can you tell us about the island?

While Kat wanted a monolithic block of stone look, we needed the storage drawers provide. The solution was to wrap the unit in dark marble-effect Dekton, complete with waterfall ends, and clad the drawer fronts in the same material. It also features a sleek induction hob with integrated ventilation, as an overhead extractor would have obstructed the view.

And the wall run?

The surfaces are designed to be kept as clutter-free as possible, hence the boiling-water tap. The fridge and freezer are integrated behind cupboard doors, while the handleless ovens open with a touch of the sensor control on the door panel.

Kat, how do you feel about the kitchen, now that it is complete?

I love the transformation – it is such a dramatic change, especially the striking colours and the contemporary design. >



To show off the cornice work, the cabinetry stops short of the ceiling. **Design.** Halcyon Interiors.



Kat Habershan and Rossi. **Tap.** Quooker.



A coffee-making zone makes it easy to prepare drinks out of the way of the cook. **Pendant.** Nordlux.



Kal and Steve can prepare dinner while chatting to friends seated on the barstools or around the dining table. **Worktop.** Cosentino; **hob.** Miele; **sink.** Blanco.



SHOP THE LOOK

1 Chelsea pendant light, £427, Innermost Plus, innermost.net 2 Easy Pro vented induction hob, £2799, Novy, novy.co.uk 3 Margaux bar stool in Paprika smart velvet, from £570, sofa.com, sofa.com 4 Goodrich Manor oak chevron engineered wood flooring, £120 per sq m, Woodpecker Flooring, woodpeckerflooring.co.uk

right The island has a monolithic look, but does not dominate.
Flooring: SPR Carpentry & Flooring; **wall paint:** Lok.



SOURCEBOOK

Kitchen Halcyon Interiors 020 7486 3080 halcyoninteriors.com
Cabinetry Eggersmann (eggersmann.com), via Halcyon Interiors, as before
Island door front cladding Optidek 01 225 464343 optidek.com
Worktops and splashback Cosentino cosentino.com
Appliances Miele 0330 160 6600 miele.co.uk
Tap Quooker 0161 768 5900 quooker.co.uk
Sinks Blanco blanco.com
Flooring SPR Carpentry & Flooring sprcarpentryflooring.co.uk
 For full stockist information, see page 126. Search for more suppliers at thethreerooms.com/directory **KBB**

The PLANS

As part of the renovation to a five-bedroom Georgian-style home, Kat and Steve Habershon created a generous open-plan kitchen-diner.

- 1 Cooking** Plenty of work surface, the hob, and a step and turn to the eye-level ovens make meal preparation easy.
- 2 Wet zone** The sink, tap, dishwasher, and waste bin are positioned close to each other for ease of use.
- 3 Socialising** Marked by a raised countertop, the L-shaped bar overhangs the island to create space for guests. It also links the cooking and dining areas.

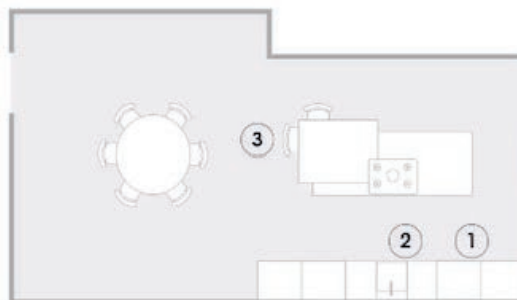



The raised worktop overhang creates a space to pull up bar stools.



Twin handleless Miele ovens are built-in at eye level, with storage above and below.



The wall units in Sand Oak were custom made by Eggersmann in Germany for Halcyon Interiors.



Each ridge of the fluted finish runs neatly from one door to the next.